

We build your Dreams....

Godwin Apartment

**PROJECT
INFORMATION**

Booklet

Overview

Our property is available at unbeatable prices in the heart of the Noida city ie Sector 110 Noida. It is available in fresh booking at one of the best location nearest to Noida-Greater Noida expressway and within 1 km radius of approved metro line going towards Pari Chowk & proposed metro line on Noida-Greater Noida expressway. Our project is low rise building with basement parking & ground + 5 floor concept. It is a 3 side open corner plot which helped us to design our project in such a manner which ensure plenty of sunlight and cross ventilation for each apartment existing in this project.

*Abstract Image, does not imply the actual project/location.



Features

Home Features
 Power Back-up
 Feng Shui / Vaastu Compliant
 Security / Fire Alarm
 Lift(s)
 Reserved Parking
 Corner Property
 Society/ Building Features
 Water Storage
 Piped-gas
 Park
 Maintenance Staff
 Security Personnel
 Visitor Parking
 Bank Attached Property



Amenities

Club house / Community Center
 Shopping Centre
 Waste Disposal
 Rain Water Harvesting

Specifications

Structure

The building will be composite RCC earthquake resistant.

Wood works

Doors and windows, all the doors will be ISI marked flush doors & windows will be wooden or aluminum.

Electrical wires

All the electrical wires will be either of FINOLEX, HAVELLS or equivalent.

Bathrooms

Ceramic tiles of KAJARIA, SOMANY, or equivalent.
CP fittings of ISI Mark

Flooring

Wooden flooring in Master Bedroom.
Vitrified tiles from KAJARIA or Equivalent.

Kitchen

Granite Counter
Two Feet tiles of KAJARIA or Equivalent above counter.
Stainless steel sink.

Lifts

Lifts for all floors OTIS or equivalent.
Covered Two Wheeler Parking.



Floor Plans

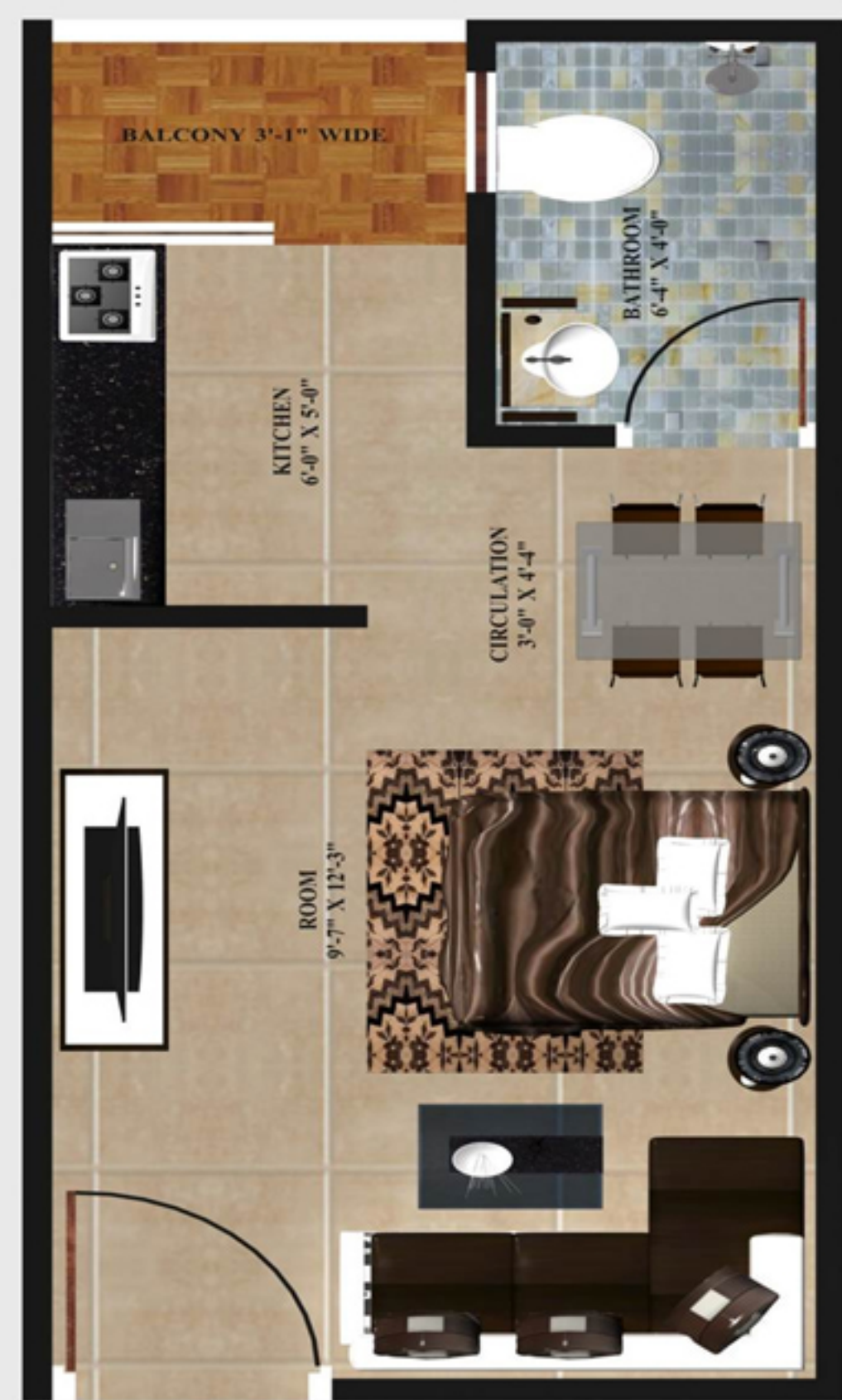



Floor Plans





For sales Enquiry

call *9916029293

@ Personalized Site Visit Request

call 1800 180180180

Email : sitevisit@commonfloor.com